

AUTUMN RIDGE

Value, simplified.





LET'S HAVE FUN.

If you're looking for a comfortable, affordable way to experience the RV camping lifestyle, look no further than the 2011 Autumn Ridge. Designed for relaxation, convenience and value, Autumn Ridge can comfortably sleep up to 9 adults, and features a range of standard equipment and optional upgrades that surpasses anything in its class, making it the perfect choice for families.

SIMPLY THE BEST CONSTRUCTION

We don't play games with our prices, and we don't make you pay for stuff you don't need. Instead, we put all of our time and energy into making a well-built, quality camper at an affordable price. In short, our campers are built for camping.

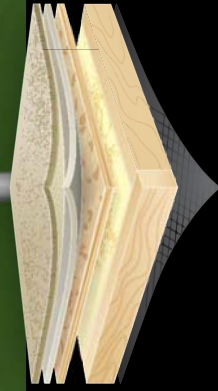

A FIRM FOUNDATION FOR DURABILITY

We use $\frac{5}{8}$ " tongue-and-groove plywood decking on 2" x 3" floor joists and R-7 fiberglass insulation to create one of the industry's most durable floors.



A STRONG, LONG-LASTING STRUCTURE

Built with 2" x 2" wooden studs, .024" aluminum exterior siding and R-7 fiberglass insulation, our walls make Autumn Ridge a strong, long-lasting structure.

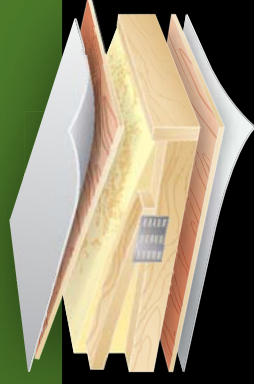

A SEAMLESS ROOF FOR PROTECTION

Featuring wooden rafters with $4\frac{1}{2}$ " arched trusses, $\frac{3}{8}$ " plywood decking, a one-piece seamless rubber membrane and R-7 fiberglass, our roof can handle the elements.

336RESA / Vanilla

264RKS / Cinnabar



GOODYEAR TIRES

Towing's a breeze thanks to 15" Goodyear radial tires, E-Z Lube axles, Torq-N-Go nuts and galvanized steel wheel wells.



OUTSIDE SPEAKERS

Enjoy your music outside with highly efficient exterior speakers (Customer Convenience Package).



22" LCD HDTV

Every night is family night with Autumn Ridge's optional 22" LCD HDTV (Premier Pkg.).



EXTENDABLE DINETTE

An extendable dinette allows you to invite more guests to dinner while offering extra storage (select models).



AIR DUCTS

You'll never feel stuffy thanks to adjustable directional ceiling ducts that deliver a 20% increase in airflow.

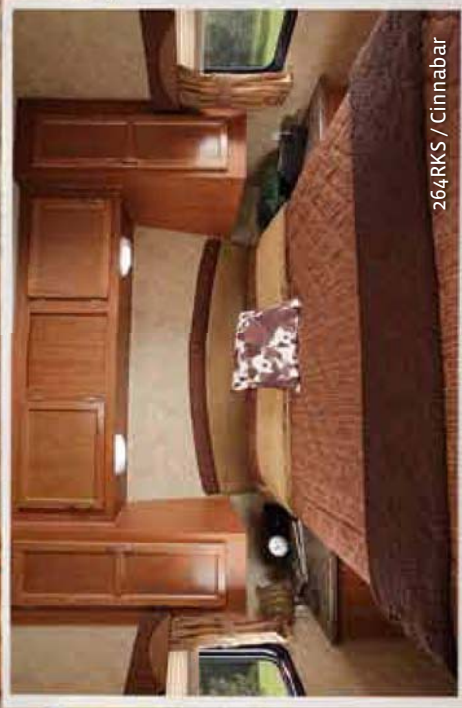

Autumn Ridge

FUNCTIONAL.

A modern kitchen, fully functional bath, multiple slideouts and an open, roomy living area are just a few of Autumn Ridge's family-friendly features. Brown Sugar cabinetry, an American-made Norcold refrigerator and residential-style furniture ensure you'll always have a great time in the great outdoors, while the Premier Package adds an electric awning, power tongue jack and raised-panel doors.



BALL BEARING DRAWER GUIDES

With a 50-lb capacity, full-extension and smooth operation, our ball bearing drawer guides provide convenience and durability.



336RESA / Vanilla



336RESA / Vanilla



264RKS / Cinnabar

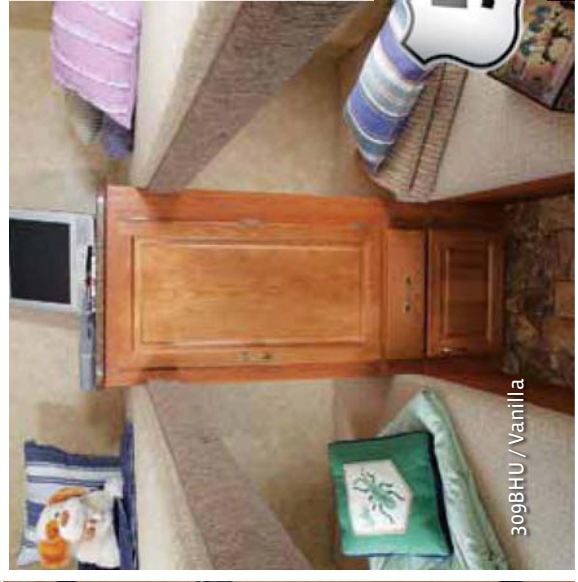

Standards and options

STANDARD BATHROOM EQUIPMENT

- Bar and towel ring
- Glass shower door (select models)
- Shower curtain with curved shower track (select models)
- Toilet paper holder
- Vinyl flooring

STANDARD BEDROOM EQUIPMENT

- 312-coil innerspring mattress with 1" padding
- Privacy curtain (select models)
- Quilted bedspread (n/a 186BH or 197FBH)
- Shirt wardrobe in bedroom
- Under-bed storage, bed lifts easily on gas struts (select models)

STANDARD KITCHEN EQUIPMENT

- 3-burner range with 9,000-BTU SuperBurner
- 6 cu. ft. flush-mount refrigerator
- Acrylic deep-bowl sink
- Brown Sugar raised-panel doors, drawers and overhead cabinetry
- Deep drawers (2) under dinette booth (select models)
- Extra large picture window at dinette
- Large pedestal dinette table
- Mixing high-rise faucet
- Oversized oven
- Range hood with light and exhaust fan (select models)
- Spice rack, built-in under kitchen sink (select models)

STANDARD CONSTRUCTION FEATURES

- 024" aluminum exterior skin
- 1/2" plywood dinette, bed and bunk platforms
- 5/8" tongue-and-groove plywood main floor decking
- 2" x 3" longitudinal floor joists on 16"-18" centers
- 81" living room ceiling height
- Electric-powered slideout (all slideout models)
- Fully decked roof with 3/8" plywood
- I-Class cambered structural-steel I-beam frame
- One-piece seamless rubber roof material
- Poly Flex one-piece underbelly covering
- R-7 fiberglass insulation in sidewalls, roof and floor
- Roof rafters, constructed of residential-style tapered 4-1/2" trusses
- Wall studs on 16" centers

STANDARD EXTERIOR EQUIPMENT

- 15" Goodyear radial tires
- 30" main entry door, black-framed

STANDARD SAFETY EQUIPMENT

- Breakaway switch
- Deadbolt lock on entrance door
- Dual hitch safety chains
- Egress window
- Fire extinguisher
- Propane/carbon monoxide alarm
- Safety-glass windows
- Smoke alarms

OPTIONS

- Customer Convenience Package
- Extendable dinette (select models)
- Free-standing table with 4 chairs (select models)
- Hide-a-bed (select models)
- Hide-a-bed on door side (336RESA)
- Outside grill
- Outside kitchen (329BHU only)
- Polar Package: Insulated, heated and enclosed underbelly, foil insulation in roof and slideout floors
- Premier Package: 22" LCD HDTV, CD/DVD player with MP3 input jack, electric tongue jack, Carefree Travel'r 12V electric patio awning, large folding grab handle, raised-panel cabinetry, raised-panel refrigerator doors (n/a 336RESA)
- Premier Package: 32" LCD HDTV with Ledgestone fireplace, CD/DVD player with MP3 input jack, electric tongue jack, Carefree Travel'r 12V electric patio awning, large folding grab handle, raised-panel cabinetry, raised-panel refrigerator doors (336RESA)
- Queen bed with bunk (197FBH)
- Roof ladder
- Spare tire with tire carrier
- Swivel rocker chairs (2) in lieu of door-side sofa (336RESA)
- Trundle bed in lieu of futon (329BHU)

CUSTOMER CONVENIENCE PACKAGE

- 6-gal. gas/electric DSI water heater
- 13,500-BTU or 15,000-BTU A/C with wall thermostat
- with lowered-directional ceiling vents
- ABS tub surround
- Bathroom power vent
- Double 30-lb. propane gas bottles with regulator
- Exterior speakers, high-output marine-grade (2)
- Front diamond plate
- Microwave oven with carousel
- Outside shower
- Tub/shower skylight
- Water heater bypass system

- Amber patio light with inside switch
- Big Easy entrance step with 10" deep treads (select models)
- Bumper with drain hose carrier and end caps
- Carefree patio awning
- Chrome hub caps
- E-Z Lube axles
- Galvanized steel wheel wells (insulated on non-slide models)
- Lockable baggage doors, radius cornered with heavy-duty grab handle
- Propane gas bottle cover, made of molded ABS
- Radius-cornered fiberglass entrance door with screen door
- Rain guttering, molded with drip spouts
- Stabilizer jacks (4)
- Torq-N-Go wheel nuts

STANDARD INTERIOR EQUIPMENT

- Ball bearing drawer guides 50-lb. capacity with full-drawer extension
- Brown Sugar doors and drawers
- Cable and satellite TV prepped
- Carpet with padding (select models)
- Crank-up digital TV antenna with signal booster
- Decorative nickel lighting over sofa and dinette
- J-Steel convertible sofa
- Maine-grade table leg and pedestal base
- Multi-media sound system AM/FM/CD stereo with MP3 input jack
- Overhead cabinetry in slideout room above sofa
- Pleated night shades
- Residential furniture, designed and made by Starcraft
- Roof-mounted antenna for radio
- Swivel rockers (select models)

STANDARD HEAT, POWER AND WATER EQUIPMENT

- 12V demand water pump
- 12V electrical system with deluxe 110V 45-amp power converter
- 30-amp power cord
- 120V G.F.C.I. protected exterior receptacle
- A/C Chiller/grille
- ABS holding tanks
- Auto-ignition furnace with wall thermostat
- Hookup for city water
- In-floor ducted heat
- Systems monitor panel
- Water system winterization kit

* A Customer Convenience Package feature



things you'll simply love:

12V electric slideouts | 6-gal. gas/electric water heater* | Plywood construction throughout | 4 stabilizer jacks | 300-lb. rated bunks

Floorplans

OPTION A
HIDE-A-BED OPTION

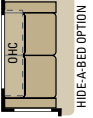

OPTION B
FREE STANDING TABLE & CHAIRS OPTION



OPTION C
EXTENDABLE DINETTE OPTION



OPTION D
UPPER BUNK
DHC
LOWER BUNK
DHC
OUTSIDE KITCHEN OPTION

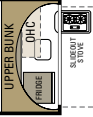

OPTION E
TOP BUNK
DHC
LOWER BUNK
DHC
TRUNDLE BED OPTION



OPTION F
DHC
DHC
DHC
LEDGESTONE FIREPLACE OPTION

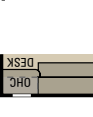

OPTION G
QUEEN UPPER BED
DHC
WARDROBE



OPTION H
CHAIR OPTION
DHC



STORAGE
HITCH
LAV
MICRO
OHC
FRIDGE
WARD

TRAILER HITCH
BATHROOM SINK
MICROWAVE
OVERHEAD CABINETS
REFRIGERATOR
WARDROBE

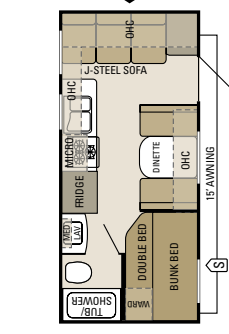

Autumn Ridge 186BH

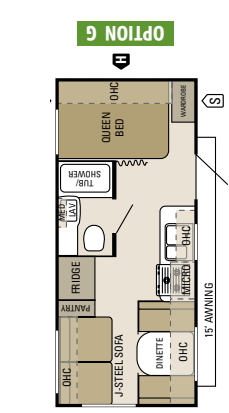

NEW Autumn Ridge 197FBH

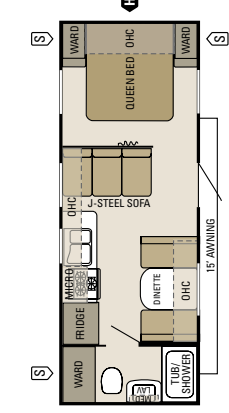

Autumn Ridge 235FB

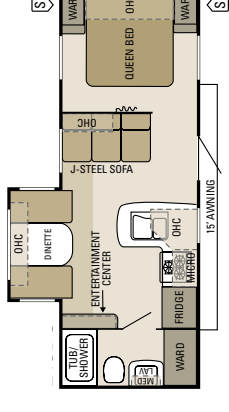

Autumn Ridge 245DS

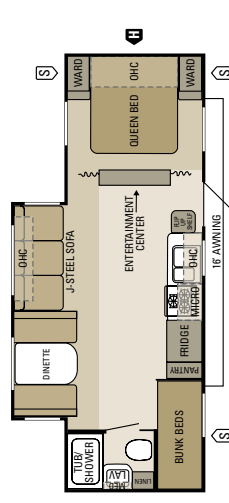

Autumn Ridge 256BHS

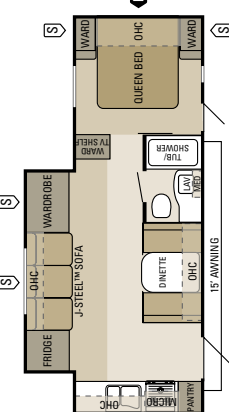

Autumn Ridge 264RKS

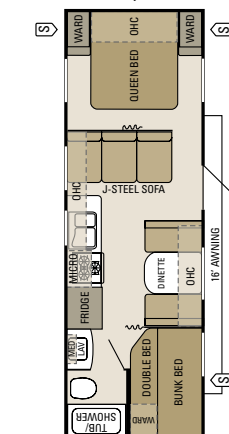

Autumn Ridge 278BH

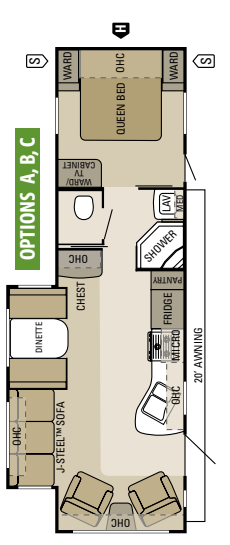

Autumn Ridge 295RLS

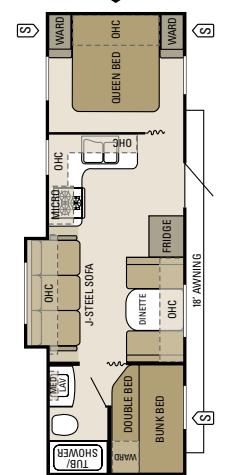

Autumn Ridge 297BHS

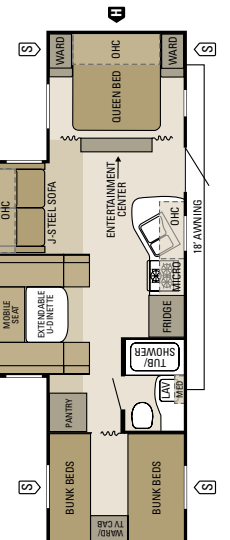

Autumn Ridge 309BHU

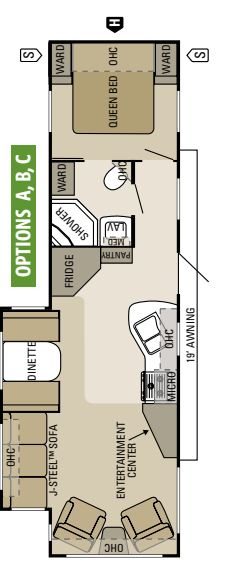

Autumn Ridge 325RLSA

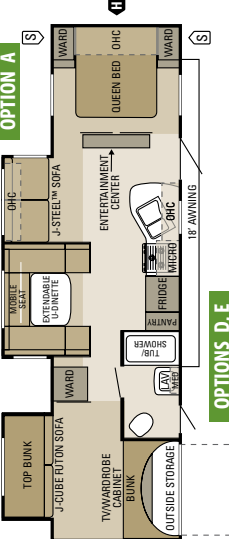

Autumn Ridge 329BHU

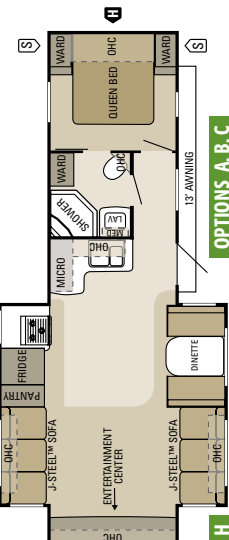

Autumn Ridge 336RESA

Décor

CINNABAR



CLANTRO



VANILLA

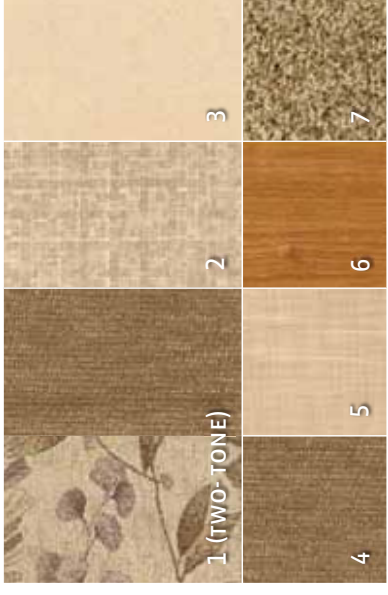

- 1 Sofa (two-tone)
- 2 Bedspread
- 3 Accent fabric
- 4 Chair
- 5 Drapery
- 6 Wood
- 7 Carpet

Specifications

Floorplan	Exterior Length	Exterior Height-AC	Interior Height	Unloaded Vehicle Weight (lbs.)	Dry Hitch Weight (lbs.)	Gross Vehicle Weight Rating (lbs.)	Cargo Carrying Capacity (lbs.)	Fresh Water Capacity (gal.) (includes water heater)	Gray Waste Water Capacity (gal.)	Black Waste Water Capacity (gal.)
186BH	22' 5"	127"	81"	4,015	490	6,000	1,985	90	32.5	32.5
197FBH	23' 3"	127"*	81"	TBD	TBD	6,500*	TBD	90	32.5	32.5
235FB	26' 5"	127"	81"	4,360	530	6,500	2,140	90	32.5	32.5
245DS	26' 11"	134"	81"	5,150	640	7,500	2,350	90	32.5	32.5
256BHS	28' 11"	134"	81"	6,005	755	8,180	2,175	86	32.5	32.5
264PKS	28' 4"	134"	81"	6,050	760	8,180	2,130	86	65	32.5
278BH	29' 1"	127"	81"	4,750	540	7,500	2,750	90	32.5	32.5
295RLS	33' 7"	134"	81"	6,820	970	9,000	2,180	86	32.5	32.5
297BHS	30' 6"	127"	81"	5,360	680	7,500	2,140	90	32.5	32.5
309BHU	33' 3"	134"	81"	6,710	950	9,250	2,540	86	32.5	32.5
325RLSA	35' 5"	134"	81"	7,025	995	9,200	2,175	86	65	32.5
329BHU	35' 6"	134"	81"	7,655	1,000	9,950	2,295	86	32.5	32.5
338ESA	35' 5"	134"	81"	7,785	915	9,950	2,165	86	32.5	32.5

*Estimate. Visit your Starcraft dealer or www.starcraftcamping.com for official spec.

Unloaded Vehicle Weight (UVW): Sometimes referred to as "Dry Weight," UVW means the typical weight of this trailer as built at the factory. The UVW, as used in product literature and other promotional materials, does not include cargo, fresh water, propane, options or dealer-installed accessories. The GVWR is equal to or greater than the sum of the UVW and the CCC.

It is important for your safety and enjoyment that your tow vehicle be adequately sized and equipped to tow and handle the GVWR of the RV you select. Review weights and rating of your tow vehicle and consult a competent advisor for questions or advice. Whether you are new to RVing or a veteran, get a fee for the performance of your tow vehicle and the RV together before heading out on the roadways. When you tow an RV, you must drive differently than you do when driving a single vehicle. Practice hooking up, driving, backing up and braking in a safe environment or seek out professional instruction. Starcraft offers a weight label to each RV which lists weight information for that vehicle. See specification chart above.

Cargo Carrying Capacity (CCC): CCC means the maximum weight of all passengers, personal items, food, fresh water, propane, tools, other cargo and dealer-installed accessories that can be carried by the trailer. CCC is equal to or less than GVWR minus UVW. The addition of options will decrease the CCC.

Hitch Weight (HW): The hitch weight, as used in product literature and other promotional materials, does not include cargo, fresh water, propane gas, options or dealer-installed accessories. The addition of these types of items will either add to or subtract, from the stated hitch weight.

Built on tradition.

The Starcraft name has been around for more than 40 years – becoming one of the most dependable names in the camping industry. Today, our strong balance sheet and family-oriented business approach means we'll be around for decades to come. And you can bet our campers will continue to come with everything you need to have a great time in the great outdoors, at a price that guarantees you will.

One-year warranty

The Starcraft warranty is a manufacturer's limited warranty. Each Starcraft is warranted to the original purchaser for twelve (12) months from the original date of purchase against defects in materials and workmanship. Starcraft's limited warranty is not transferable. For a copy of the limited warranty with full terms and conditions, ask your local Starcraft dealer.

One-year roadside assistance

Travel worry-free with the complimentary Coach-Net Roadside Assistance program, which gives you immediate access to dependable roadside assistance with a simple phone call.

Why a Local Starcraft Dealer is Important to You

Establishing a solid relationship with your local Starcraft dealer is a key component in the enjoyment of your new Starcraft. By purchasing from a local dealer, you will have a convenient location for sales, parts and service support.



STARCRAFT

CAMPING | *pure and simple.*

© Starcraft RV • Topeka, IN 

www.starcraftcamping.com

See dealer for further information and prices. All information in this brochure is the latest available at the time of publication approval. Starcraft reserves the right to make changes and to discontinue models without notice or obligation. Photos in this brochure may show optional equipment and props for photography purposes. RV's built for sale in Canada may differ to conform to Canadian codes.

www.starcraftcamping.com | STOP BY OUR HOME ON THE WEB FOR MORE INFORMATION OR TO FIND A DEALER NEAR YOU.